



# B103-C2-H

## Water Bottle Filling Station with Dual Cup Dispenser and Water Heater



Water bottle filling station and chiller cabinet shown in #4 satin standard stainless steel finish with "Soft Touch" button valve in mirror finish, a water heater and dual cup dispensers

Dimensions in drawing subject to options selected.

### Features

- Long-lasting, durable stainless steel water dispenser, promotes refilling of water bottles
- Bottom-loading dual cup dispensers hold approx. 100 standard 9 oz. paper cups
- 100% made in the USA
- No plastic parts
- Manufactured with lead-free materials
- Integral drain for ease of cleaning
- Matching cover plate finishes including unlimited powder coat colors
- Options include sensor activation, bottle counters, finishes, and much more...

### Top View

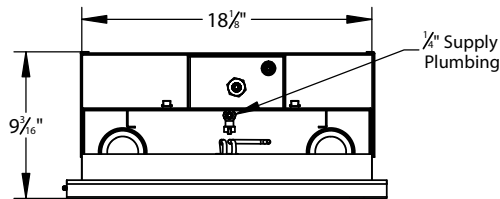

### Side View

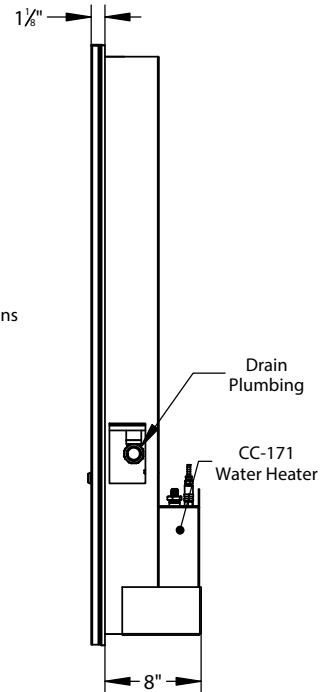

### Front View

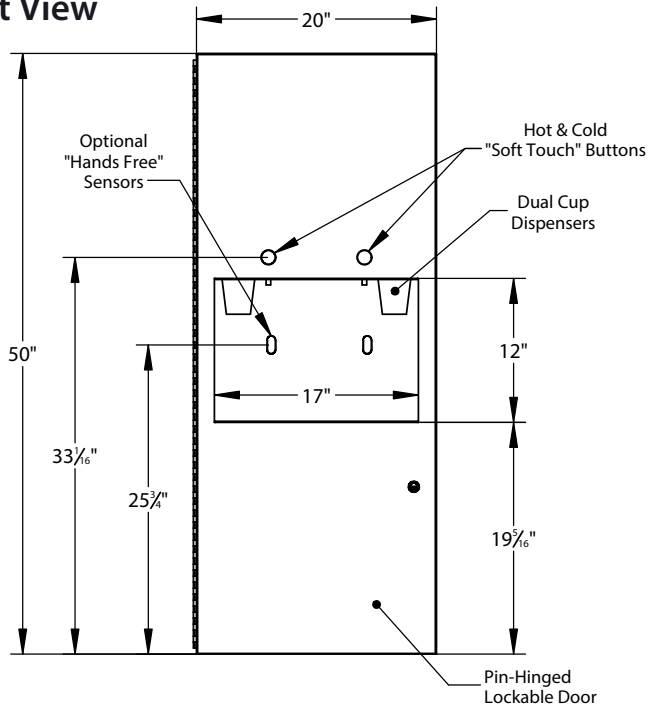

For options, finishes and more see page 2

### B103-C2-H Models Include:

#### Heater: Model CC-171

- **Water In:** 1/4" FPT
- **Capacity:** Approx. 72 oz
- **Storage Tank:** Stainless Steel
- **Housing:** Enameled Aluminum
- **Electrical:** 500W, 110-120/60/1 Supplied with 6' Wall Plug

### Recommended Add-ons:

#### Chiller

Equip your fountain with a Filtrine point-of-use or remote chiller to cool your drinking water. We can help you select the most economical chiller model to fit your demand.

#### Purifier

Ensure that your drinking water is one of the highest quality by adding a Filtrine Taste Master purifier cabinet underneath the fountain or a remote purification system serving all fountains in the building.





# Filtrine Water Bottle Filling Station Options

[S] - Standard  
[ADA] - ADA compliant

## Bottle Filling Station Controls (Check One)

Flush Mounted "Soft Touch" Button Valve [S]



Flush Mount "Soft Touch" Push Button

Optional Sensor Activated Valve

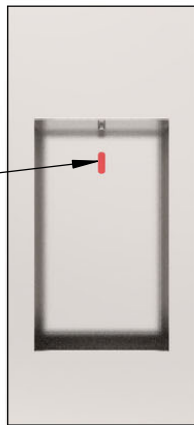

"Hands Free" Sensor Activator

- Features automatic shutoff with [30] second delay
- Uses [4] AA batteries (included)
- 120/60/1 voltage available

### "Soft Touch" Button: Material

- Stainless Steel [S]    Bronze

### "Soft Touch" Button: Finish

- Satin    Mirror    Statuary Bronze    Oil Rubbed Bronze  
 Powder Coat \_\_\_\_\_

### Bottle Counter

Digital display of approximate number of bottles saved through fountain usage



Note: Only available with sensor activation

## Other Bottle Filling Station Models:

### Purifier Model B103-TM

Ensure that your drinking water is of the highest quality by adding a Filtrine Taste Master® purifier to the bottle filling station. The carbon block within the purifier removes particulates, cysts, chlorine, organic odors and tastes.



### Cup Dispensers Models B103-C2 & -CD2

Model B103-C2 water bottle fillers are equipped with dual cup dispensers (bottom loading) and hold approximately 100 standard paper cups. For convenient cup disposal, specify Filtrine's B103-CD2 models that come with a cup disposal bin.



### Water Heater Model B103-C2-HC

Add a built-in "instant" water heater for hot beverages on demand. Our Model B103-C2-HC is the industry's only in-wall bottle filling station that dispenses both regular and hot drinking water.



### Water Chiller Model FCC-B103

Equip your fountain with a Filtrine point-of-use or remote chiller to cool your drinking water. We can help you select the most economical chiller model to fit your demand.



### Combination Model B103-107

Combine two of our most popular water dispensers in an all-in-one space-saving unit. Give users the option of filling a water bottle or drinking directly from a fountain.



For the complete list of Bottle Filling Station models go to [Filtrine.com](http://Filtrine.com)

## Interior Surface: Material (Check One)

- Stainless Steel [S]    Bronze

## Interior Surface: Finish (Check One)

- Satin Stainless [S]    Mirrored Stainless    Powder Coat \_\_\_\_\_    Satin Bronze    Mirrored Bronze    Statuary Bronze    Oil-Rubbed Bronze

## Exterior Surface: Material (Check One)

- Stainless Steel [S]    Bronze

## Exterior Surface: Finish (Check One)

- Satin Stainless [S]    Mirrored Stainless    Powder Coat \_\_\_\_\_    Satin Bronze    Mirrored Bronze    Statuary Bronze    Oil-Rubbed Bronze

### Stainless



Satin Stainless Steel [S]



Mirrored Stainless Steel

### Bronze



Satin Bronze



Mirrored Bronze



Oil Rubbed Bronze



Statuary Bronze

### Powder Coat



White



Choose from an unlimited array of powder coat colors to match any decor!



## Mounting Details (Front)

All views shown are for typical installation of B103-C2-H. Views, dimensions and diagrams may change for specific installation requirements.

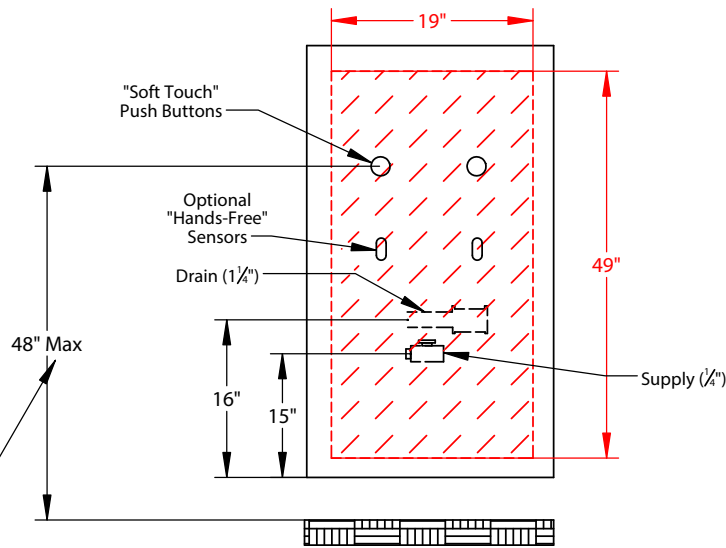

Approximate Rough-In Dimensions (hatched, left)

Model	Height	Width	Depth
Standard	49"	19"	8 1/2"

per ADA compliance

## Exploded On-Wall Installation View of B103-C2-H Filling Station

### Typical Assembly Instructions (Always Install Per Local Code)

1. Cut rough opening for filling station as shown above.
2. Install blocking as required to fasten the unit high and low on both sides.
3. Run drain piping to center of opening for 1 1/4" slip coupling connection to the drain elbow and install drain trap in wall per local code.
4. Run supply water lines to the center of the opening for 1/4" FPT connection to stop valve.
5. Install the filling station fixture with 3/16" lag screws to support blocking.
6. Insert water heater into the cabinet.
7. Connect drain to trap (provided in field) and slip coupling (provided by factory).
8. Connect one water line to 1/4" FPT connection of the water heater and the other to the cold water stop valve at the top. Use plumber's tape and crescent wrench to ensure all connections are tight.
9. Connect water line from the heater to the hot water ball valve at the top of the unit using piping provided by Filtrine.
10. Turn stop valve to "on" position and test water flow from the filler valve. Water should fill a 12oz bottle in 15 seconds or less. Adjust flow at regulator if required with straight screw driver.

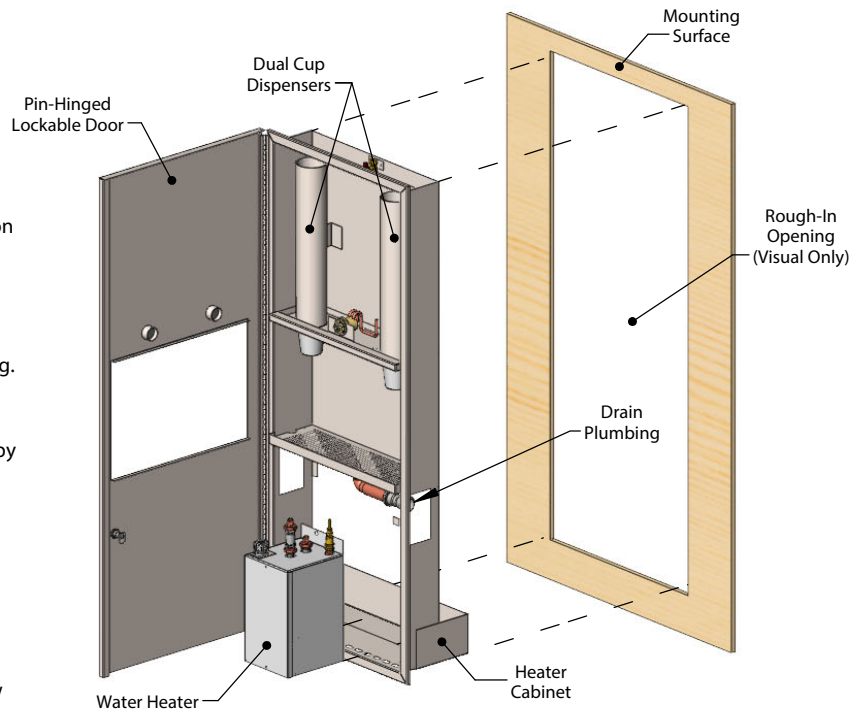

## Heater Cabinet Dimensions

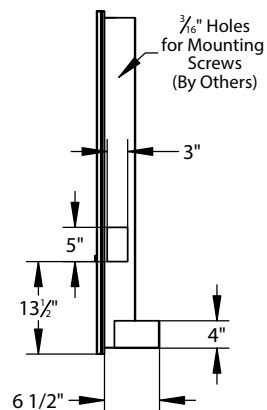

## Typical Drain Plumbing Detail (In-Wall Plumbing Provided By Others, Install Per Local Code)

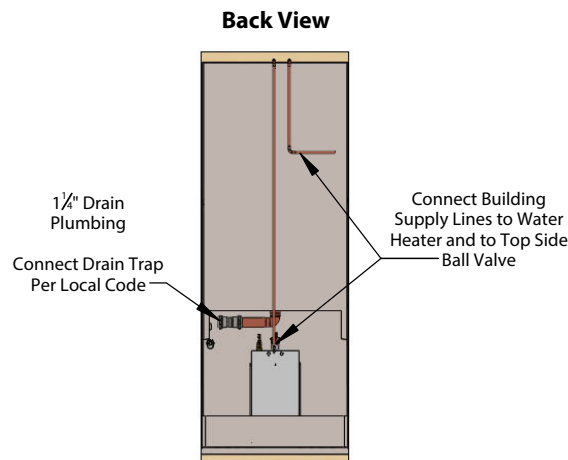

## Top View

