

102

Semi-Recessed Drinking Fountain



*Fountain shown in
satin bronze finish*

FOUNTAIN SPECIFICATIONS

FOUNTAIN MATERIAL - 16 gauge

- ☐ Stainless Steel ☐ Bronze

FINISH

- ☐ Satin [S] ☐ Satin [S]
☐ Mirror** ☐ Mirror**
☐ Powder Coat ☐ Statuary Bronze
 Color _____ ☐ Oil Rubbed Bronze

FOUNTAIN CONTROL OPTIONS

- ☐ Separate "SOFT TOUCH" button valve [S]* 
☐ Integral "PUSH BUTTON" valve
☐ Integral "EASY TOUCH" lever valve

NOTE: Finish to match bowl except stainless steel "Soft Touch" valve is only available in mirror.

VANDAL-PROOF FOUNTAIN OPTIONS

- ☐ BUBBLER secured with tamper-resistant set screws
☐ BUBBLER operated by "HANDS-FREE" sensor

BOTTLE FILLER OPTIONS

- ☐ BOTTLE FILLER mounted on back over fountain

ACCESS PANEL OPTIONS

- ☐ ACCESS PANEL mounted under fountain. 6" or specify: _____
NOTE: Included with Hands-Free Sensor

*ADA compliant, less than [5] lbs force to activate

**Check on availability with factory

[S] = STANDARD

102 Drawing

TOP VIEW

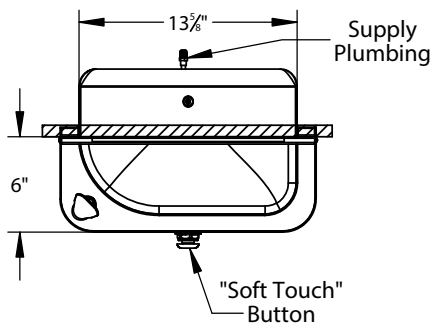

WALL OPENING W/O BOTTLE FILLER
15" W x 4 1/2" D x 27 1/2"

WALL OPENING W/ BOTTLE FILLER
15" W x 6 1/2" D x 27 1/2"

FRONT VIEW

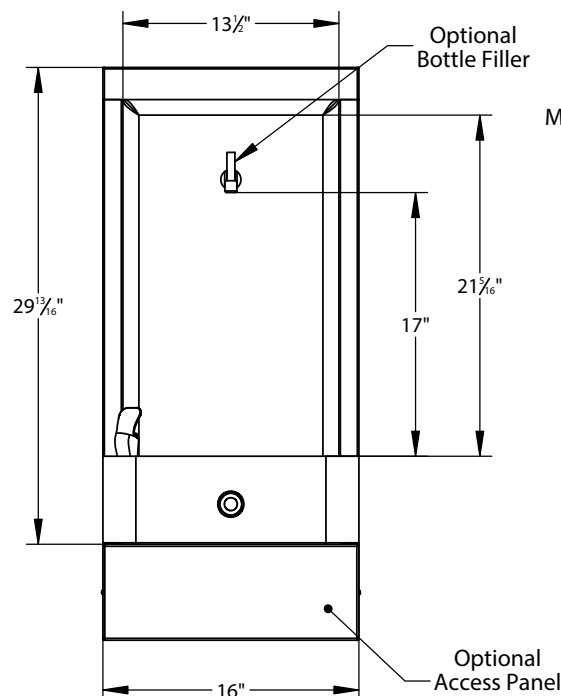

SIDE VIEW

