



90-TM-HF

Touchless Non-Recessed Drinking Fountain with Purifier and "Hands Free" Sensors



Fountain bowl, purifier cabinet and optional "Hands Free" gooseneck bottle filler shown in #4 satin standard stainless steel finish with "Hands Free" sensors, label and bubbler in mirror finish

Dimensions in drawing subject to options selected.

Features

- 10½" diameter, 16 ga. fountain bowl
- Long-lasting, durable stainless steel water dispenser, promotes refilling of water bottles
- "Hands Free" sensors help prevent germ transmission and water waste
- One-piece cover plate with no seams or exposed edges
- No plastic parts
- Integral drain in bowl for ease of cleaning
- ¼" steel support arm and wall bracket capable of supporting 500 lbs.
- Matching cover plate finishes including unlimited powder coat colors
- Options include "Hands Free" bottle fillers, bottle counters, finishes, bubbler valves and much more...

90-TM-HF Models Include:

Purifier: Taste Master® TMS1-0.5

- **Construction:** Stainless steel housing
- **Element:** Carbon block removes lead, particulates, cysts, chlorine, organic odors and tastes. Exclusive seal design negates bypassing and leaking

Recommended Add-ons

Chiller

Equip your fountain with a Filtrine point-of-use or remote chiller to cool your drinking water. We can help you select the most economical chiller model to fit your demand.

Top View

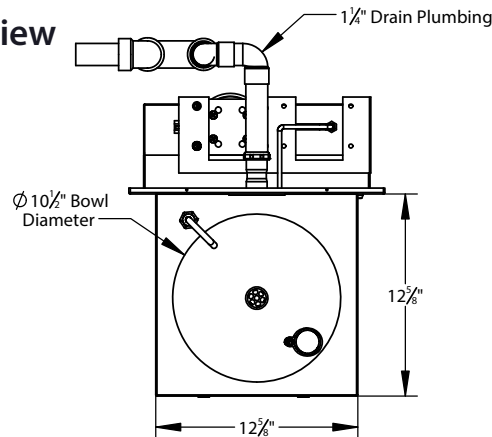

Side View

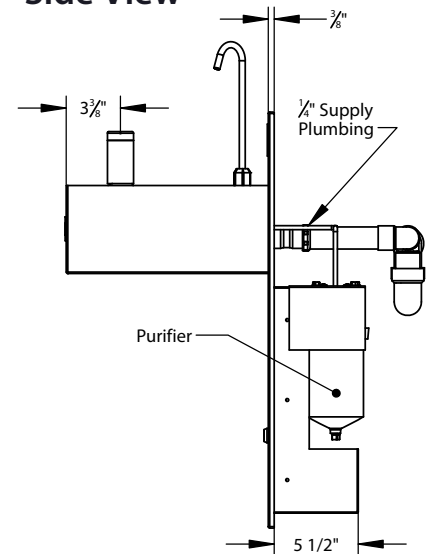

Front View

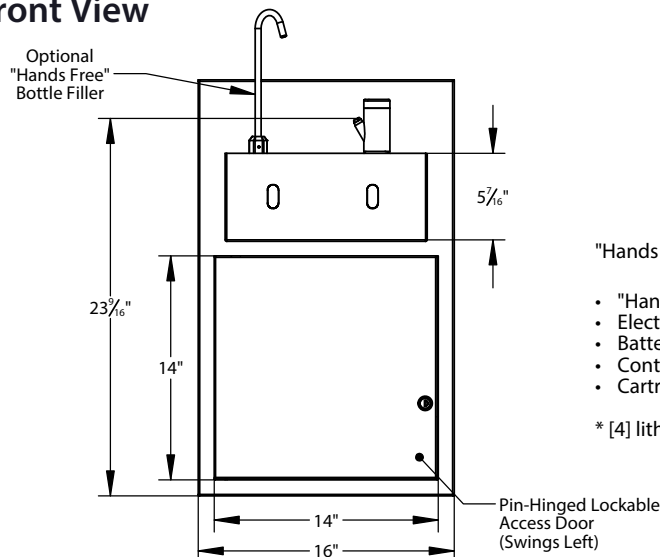

"Hands Free" Components Include:

- "Hands Free" Sensor
- Electrical Box
- Battery Pack*
- Control Module
- Cartridge Regulator

* [4] lithium AA batteries included

For options, finishes and more see page 2

☐ **Labels** (Choose one or both [S])



☐ **Optional "Hands Free" Gooseneck Bottle Filler**



- Mounted on deck of lowest fountain bowl
- "Hands Free" sensor features automatic shutoff with [30] second delay
- Supply plumbing and mounting fitting for filler provided by Filtrine

☐ *Tamper resistant screws prevent vandalism*

Model CC-153-STV

Vandal Proof Options

☐ **Optional "Hands Free" Vandal Proof Bottle Filler**

- Mounted 10½" above lowest fountain bowl.
- Comes standard with bottom security panel assembled with tamper proof screws.
- Requires larger cover plate and mounting plate.
- Supply plumbing and mounting tongue for filler provided by Filtrine.



☐ **Optional Tamper-Resistant Screw**

Tamper-Resistant Set Screw
 Secures Bubbler to Fountain

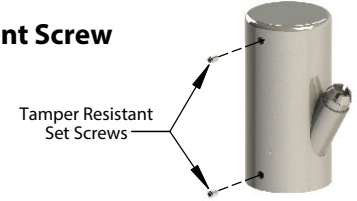

☐ **Optional Security Panel**

16 ga. Plate
 Secured with
 Tamper-Resistant
 Screws for Added
 Security

4x-Tamper
 Resistant Screws

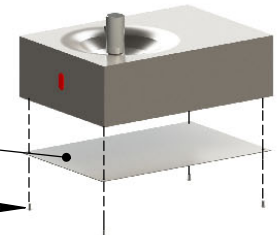

☐ **Optional F-502 Bubbler**

Alternative "Hands Free" Bubbler
 to the Default F-503 Bubbler

☐ **Optional F-502 Tamper Resistant Screw**

Tamper-Resistant Set Screw
 Secures Bubbler to Fountain

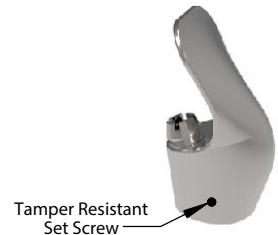

Fountain Finish (Check One)

☐ Satin Stainless [S] ☐ Mirrored Stainless ☐ Powder Coat _____ ☐ Satin Bronze ☐ Mirrored Bronze ☐ Statuary Bronze ☐ Oil-Rubbed Bronze

Optional Cover Plate Finish (Check One)

☐ Satin Stainless [S] ☐ Mirrored Stainless ☐ Powder Coat _____ ☐ Satin Bronze ☐ Mirrored Bronze ☐ Statuary Bronze ☐ Oil-Rubbed Bronze

Stainless



Satin Stainless Steel [S]

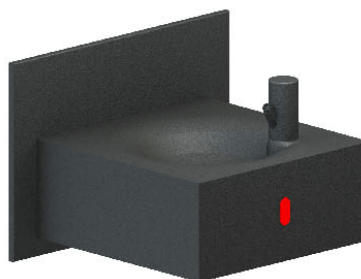

Black Powder Coat



Mirrored Stainless Steel



White Powder Coat

Bronze

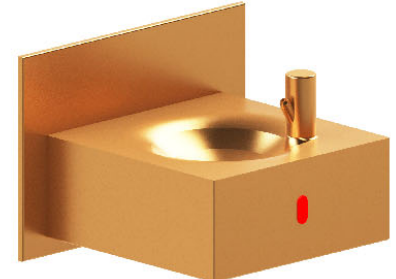

Satin Bronze



Statuary Bronze

Mounting Plate Details (Front)

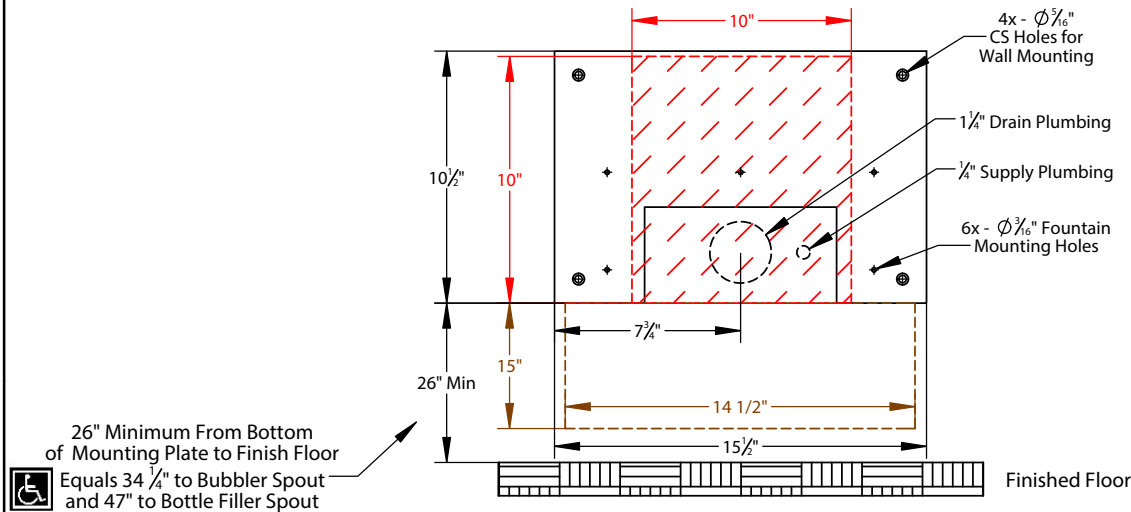

Approximate Rough-In Dimensions (hatched, left)

Model	Height	Width
Standard Plate	10"	10"

Approximate Access Panel Rough-In Dimensions (outlined, left)

Model	Height	Width
Purifier Cabinet	15"*	14 1/2"

*If height specified, rough-in height will be 1/2" less than specified height

All views shown are for typical installation of 90-TM-HF. Views, dimensions and diagrams may change for specific installation requirements.

Exploded On-Wall Installation View 90-TM-HF

Typical Assembly Instructions (Always Install Per Local Code)

1. Cut rough opening for fountain and purifier cabinet as shown above.
2. Run drain piping to the rough opening and install drain trap per local code
3. Run supply water lines to bottom of rough opening.
4. Fasten mounting plate over rough opening with $\frac{5}{16}$ " countersunk lag bolts with bottom of plate 26" above the floor to meet ADA fountain height requirements.
5. Install cover plate and cabinet over the mounting plate.
6. Install the model 90-HF fountain using screws provided.
7. Connect drain line to slip coupling and building supply plumbing to 1/4" connection at purifier. Install AA batteries.
8. Activate sensor to test water flow. Adjust flow rate by turning the white screw head on the regulator cartridge (turn clockwise to decrease flow, counterclockwise to increase flow).
9. To adjust sensor distance, turn the yellow phillips head screw on control module (turn clockwise to lengthen distance).

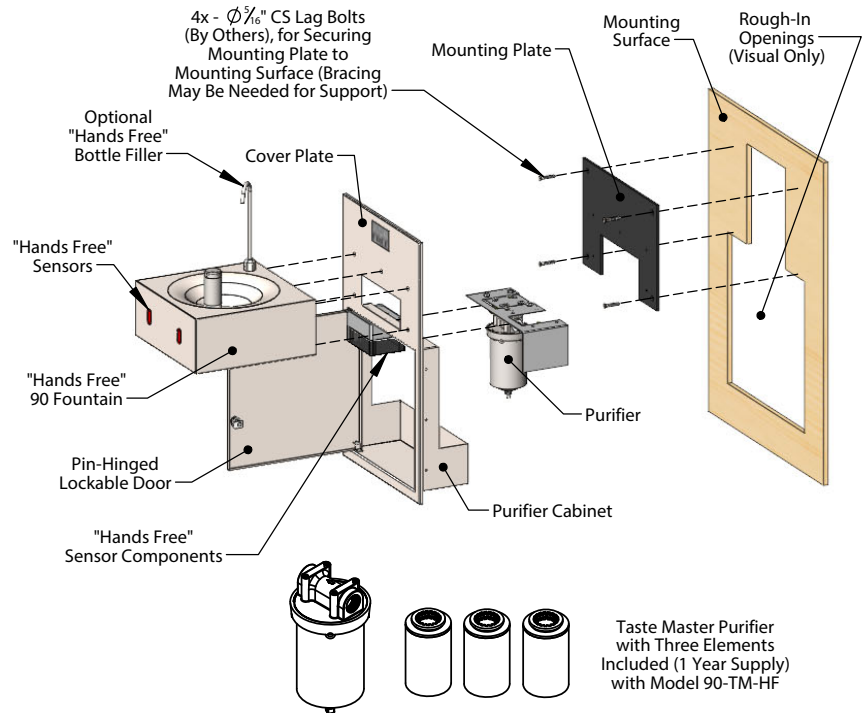

Purifier Cabinet Mounting Details

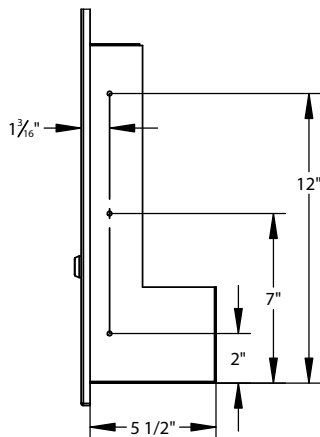

Typical Drain Plumbing Detail (In-Wall Plumbing Provided By Others, Install Per Local Code)

