



FILTRINE FOUNTAIN COLLECTION

Model 107-MA

Non-Recessed Marble Fountain



16 gauge mirror finish bronze bowl shown in a polished marble ring with matching support arm and "Push Button" bubbler.

Filtrine Fountain Collection

Model 107-MA Marble Non-Recessed Fountain

Features

- 10" diameter, 16 ga. stainless steel or bronze fountain bowl, set into a circular marble fountain deck (multiple marble types and colors available)
- $\frac{1}{4}$ " steel mounting plate with a welded $\frac{3}{8}$ " steel tongue extending into support arm for maximum horizontal stability, capable of supporting 500 lbs.
- Sleek looking 14 ga. support arm. Material and finish to match bowl.
- Manufactured with lead-free materials
- 100% made in USA
- No plastic parts

Standard 107-MA fountain shown. Wheelchair accessible fountains and other options available upon request.

Fountain Options

Bowl Material Finishes

Bronze:

- ☐ Satin
- ☐ Mirrored
- ☐ Statuary
- ☐ Oil-Rubbed

Stainless Steel [S]:

- ☐ Satin [S]
- ☐ Mirrored

Marble Ring:

Marble Type: _____

Marble Color: _____

Fountain Bubbler Controls (finish to match bowl)

- ☐ Separate "Soft-Touch" button valve [S]
- ☐ Integral "Push Button" valve
- ☐ "Easy-Touch" lever valve

Mounting and Installation Options

- ☐ On-wall installation (matching 16" x 11" cover plate)
- ☐ In-wall installation (no cover plate)

107-MA Drawing

Dimensions in drawing subject to options selected.

Top View

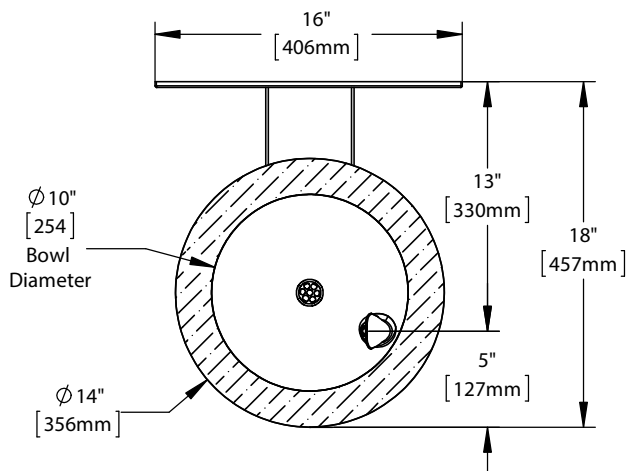

Front View

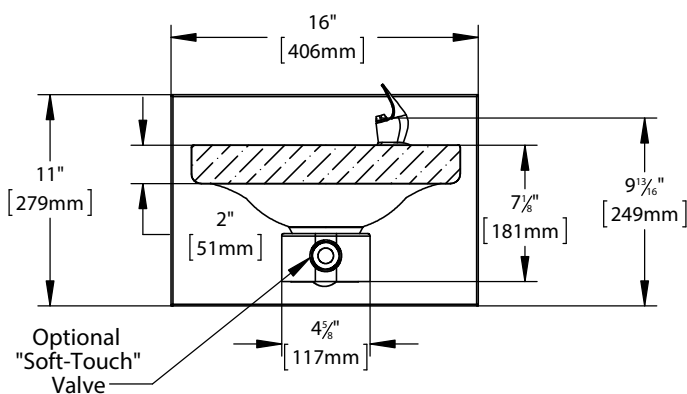

Mounting Plate

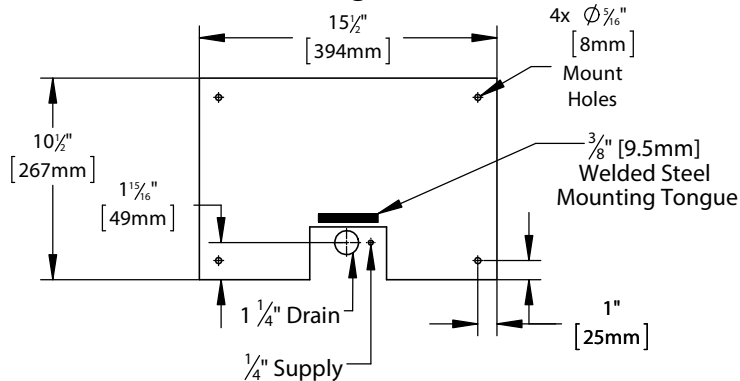

Side View (On-Wall Installation)

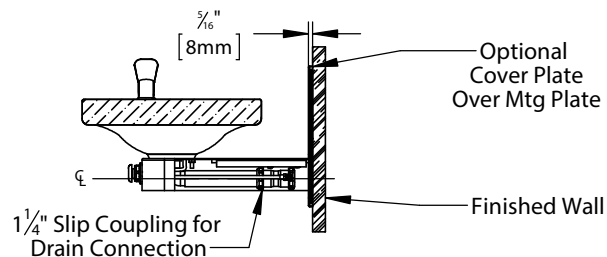

Side View (In-Wall Installation)

