



# FILTRINE FOUNTAIN COLLECTION

Model 108-WD-HL

Non-Recessed Wooden Fountain



16 gauge satin finish bronze high/low bowls  
shown in cherry wood rings with matching  
support arms and "Soft Touch" bubblers.



# Filtrine Fountain Collection

## Model 108-WD-HL Wooden High/Low Non-Recessed Fountain

### Features

- [2] 10" diameter, 16 ga. stainless steel or bronze fountain bowls, set into circular wooden fountain decks (multiple wood types and colors available)
- $\frac{1}{4}$ " steel mounting plate with welded  $\frac{3}{8}$ " steel tongues extending into support arms for maximum horizontal stability, capable of supporting 500 lbs.
- Sleek looking 14 ga. support arms. Material and finish to match bowl.
- Manufactured with lead-free materials
- 100% made in USA
- No plastic parts

Standard 107-WD-HL fountain shown. Wheelchair accessible fountains and other options available upon request.

### Fountain Options

#### Bowl Material Finishes

##### Bronze:

- ☐ Satin
- ☐ Mirrored
- ☐ Statuary
- ☐ Oil-Rubbed

##### Stainless Steel [S]:

- ☐ Satin [S]
- ☐ Mirrored

#### Wooden Ring Material:

- ☐ Cherry [S]
- ☐ Mahogany
- ☐ Teak
- ☐ Bamboo
- ☐ Walnut

#### Fountain Bubbler Controls (finish to match bowl)

- ☐ Separate "Soft-Touch" button valve [S]
- ☐ Integral "Push Button" valve
- ☐ "Easy-Touch" lever valve
- ☐ "Hands Free" Sensor

#### Mounting and Installation Options

- ☐ On-wall installation (matching 16" x 32" cover plate)
- ☐ In-wall installation (no cover plate)

#### Optional Access Panel

- ☐ 6" High Access Panel (Included with "Hands Free" Sensor)

### Optional "Hands Free" Sensor

- Uses 4x - AA lithium batteries (included), runs approximately 400,000 activation cycles
- Features automatic shutoff (30 sec)
- Helps prevent germ transmission, vandalism and water waste



Dimensions in drawing subject to options selected.

Top View

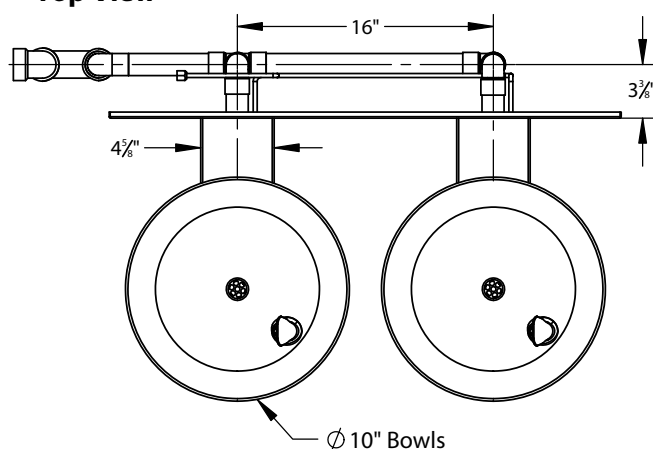

Drain Plumbing Depth

Side View

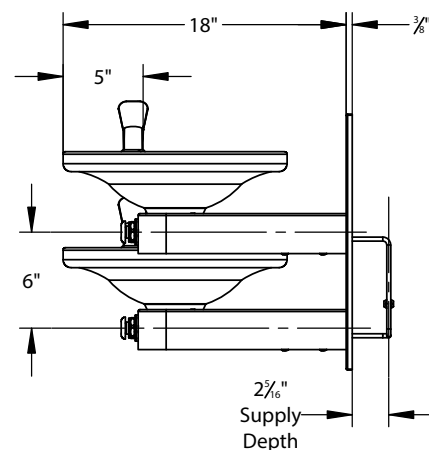

Front View

